

Reconstitution Instructions



How Can I Dispose of Used Syringes and Needles?

You can purchase a sharps container, which is a hard-plastic container made especially for used syringes and needles, at your local pharmacy. If you did not purchase this container with your medication, you can use a hard-plastic container with a screw-on top, such as a clothing softener or hard-plastic detergent bottle. Make sure you can easily put both the syringe and the needle into the container.

Whatever container you choose, make sure that the needles cannot break through the sides, bottom or top.

Call your primary care physician or your local pharmacy to find out what your state or local requirements are for disposing of used syringes and needles.

For more information about how to properly dispose of sharps, ask your medical provider or local pharmacy for details. More information is available at safeneedledisposal.org.

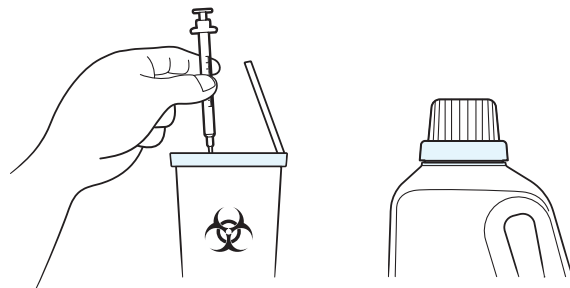

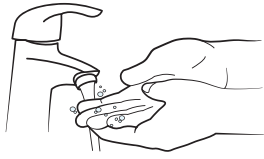

1
Wash hands thoroughly and assemble the necessary supplies on a clean surface.

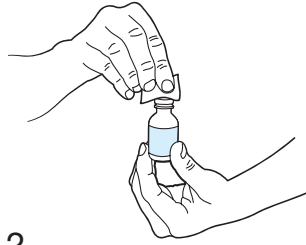

2
Remove the plastic caps from the vials containing the Freeze Dried Medication and Bacteriostatic Water. Wipe the tops of the vials with alcohol pads and let dry.

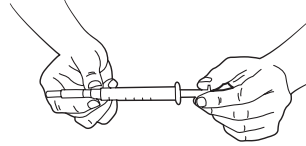

3
Using the provided mixing syringe, TIGHTEN THE NEEDLE TO THE HUB then pull back the plunger to the volume to be reconstituted.

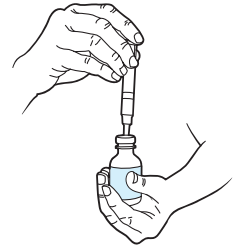

4
Insert the needle into the Bacteriostatic Water and push the plunger in.

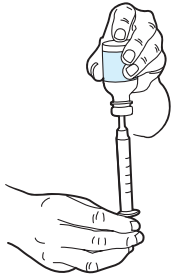

5
Draw out the amount of Bacteriostatic Water directed on your prescription by slowly pulling the plunger back.

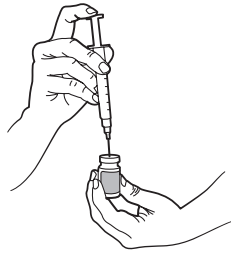

6
Remove the needle from the Bacteriostatic Water vial and insert it into the vial containing the Freeze Dried Medication.



7
Slowly push in the plunger to transfer the Bacteriostatic Water within the syringe into the vial containing the Freeze Dried Medication.

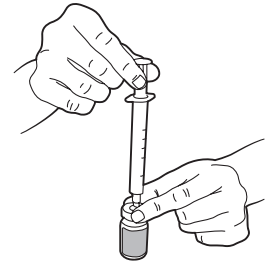

8
Draw out the same volume of air that was injected from the vial containing the Freeze Dried Medication before removing the needle. This will keep the pressure equal within the vial.

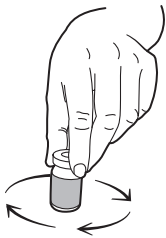

9
Swirl the vial until the solution is clear.

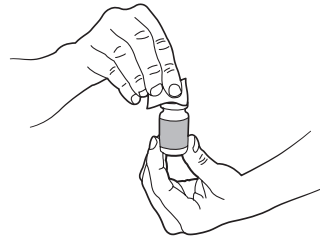

10
Please note that prior to inserting the syringe into the vial you should first wipe the top of the vial with an alcohol pad.

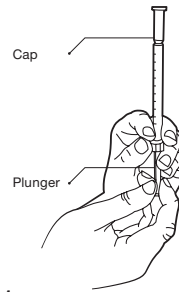

11
Obtain a new injection syringe. Bring air into the syringe by pulling back the plunger to the amount of volume to be injected then remove the cap from the syringe.

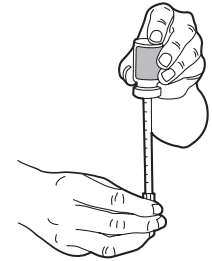

12
Insert the needle into the vial containing the Medication. Push the plunger in and turn the syringe with the vial upside down. Pull back the plunger to transfer the desired amount of liquid into the syringe.

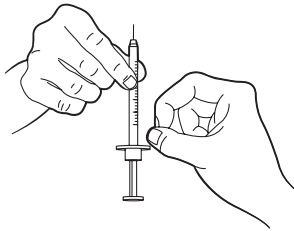

13
Remove the needle from the vial containing the Medication then point the needle up and gently tap on the syringe until all bubbles rise to the top.

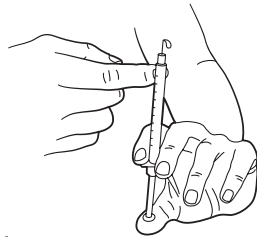

14
To expell air bubbles contained within the syringe slowly push the plunger until a small drop forms on the tip of the needle.

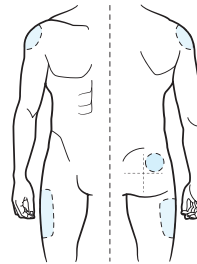

15
Choose an injection site recommended by your physician.

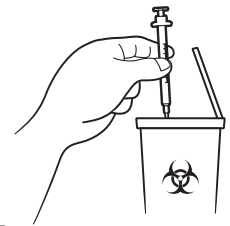

16
Discard the syringe and any other supplies containing needles into the needle disposal container.